

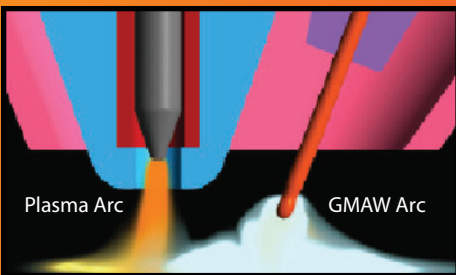

# Super MIG<sup>®</sup>

Hybird Welding  
Plasma & GMAW



**Principle of work:**

Plasma arc melting base material creating a keyhole, GMAW arc following and Providing the filler metal and creating full penetration.



## Welding Control Module (WCM)



## Torches

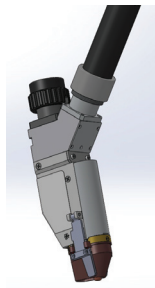

Medium Duty

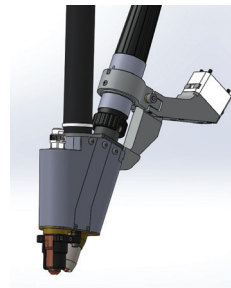

HD Slim (HDS)

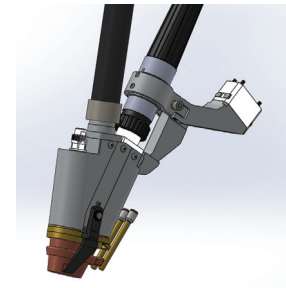

Heavy Duty (HD)

## System configuration

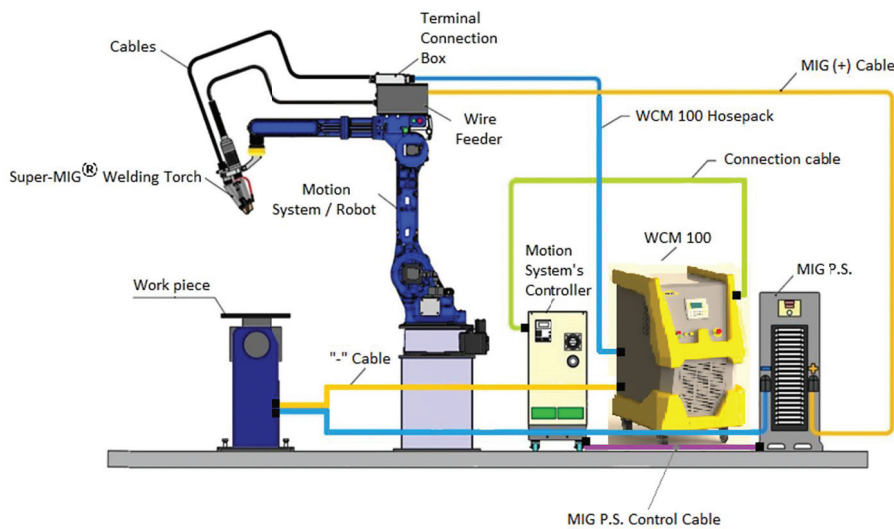

## Applications

- Mainly welding 5mm thick and above
- Boilers (steel & stainless)
- Autoclaves
- Heat exchangers
- Construction parts-H/T beams
- Crane Booms
- Silos & containers
- Shipyards
- Armored steel constructions
- Earth moving machinery

## SMIG® performances and advantages

- Welds Up to 12 mm thick, one pass, no preparation
- Deep weld penetration
- High weld travel speeds
- Reduced heat input
- Narrow heat affected zone

WORKPIECE MATERIAL	WORKPIECE THICKNESS (mm)	WELD PASSES	TRAVEL SPEED m/min	PLASMA ARC PARAMETERS	GMAW ARC PARAMETERS			
				CURRENT (A)	WIRE FEED RATE m/min	VOLTAGE (V)	CURRENT (A)	WIRE DIA (mm)
Carbon Steel	6	1	1	220	12	26.5	350	1.2
Carbon Steel	8	1	0.75	200	12.5	30.5	350	1.2
Carbon Steel	12	1	0.45	240	10	32	592	1.6
Armored Steel	8	1	0.8	220	14.5	25	360	1.2
Armored Steel	8	1	0.5	300	12.3	20.6	330	1.2
Armored Steel	8	1	0.7	280	12	26	312	1.2
Stainless Steel	6	1	0.6	150	10	27.6	251	1.2
Stainless Steel	9	1	0.6	150	11.7	28.9	285	1.2
Stainless Steel	10	1	0.85	190	22	35.9	520	1.2



### Global Headquarters

Kibutz Eyal, ISRAEL 4584000  
 P.O box: 170  
 Office: 972-9-7714233  
 Fax: 972-722-640240  
 Menachem Gilad – mgilad@weldobot.com  
 Sales: Gali Geler – gali@weldobot.com

### Weldobot Europe

Zlota 59 00-120 Warszawa  
 Contact: Mr. Tadeusz Keshet  
 Office : +48 22 438 63 00  
 Mobile : +48 604 479 111

### Weldobot Technologies Inc.

1683 W. Hamlin Road (Tech Center)  
 Rochester Hills, MI 48309 USA  
 Contact: Mr. Ryan Kot  
 Office: +1-248-289-6760  
 Fax: +1-248-289-6659  
 Mobile: +1-810-498-8886  
 rkot@weldobot.com